

EB300

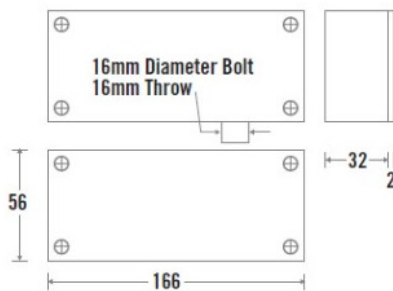

12VDC SURFACE FAIL SAFE SOLENOID BOLT

This solenoid bolt is ideal for use on timber or metal doors where a surface option is possible. Suitable for single or double action doors it provides a secure locking method and includes door position monitoring and variable re-locking delay.

FEATURES

- Suitable for horizontal or vertical installation
- Fail safe (power to lock)
- Door position monitoring
- Variable re-lock delay
- Low holding current
- Anti-tamper design
- Suitable for single or double-action doors

TECHNICAL INFORMATION

- Input voltage: 12Vdc $\pm 10\%$
- Activating current 900mA
- Holding current 300mA
- Bolt diameter 16mm
- Bolt throw 16mm
- Monitoring contacts: SPDT (COM, NO, NC) rated 250mA @ 30Vdc
- Operating temp: -10°C to 45°C
- Humidity: 0~95% non-condensing

RELATED PRODUCTS

